

PHONE: (07) 5411 4209 (Option 2)
OR (02) 8004 3333 (Option 2)

WEBSITE: tbafirefly.com.au
EMAIL: sales@tbafirefly.com.au

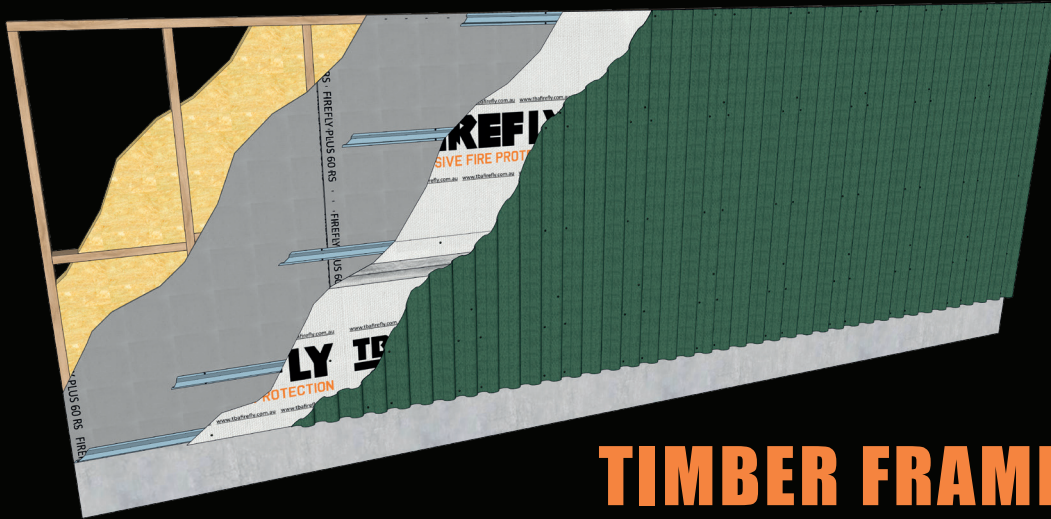

TIMBER FRAME

CERTIFICATION

Tested in accordance with AS1530.8.2
 Warringtonfire Report: FAS200015 RIR

**AS1530.8.2
 CLASSIFICATION
 BAL-FZ**

APPLICATIONS

Our AS1530.8.2 BAL-FZ Wall System allows for Lightweight Timber Framed buildings to be built in bushfire areas which have been designated as being in the highest Bushfire Attack Level-Flame Zone. Simply install our lightweight products and clad with steel sheeting to weather proof the building. This system must be installed in strict accordance with the compliance Report and incorporate all products of the system.

In accordance with AS3959:2018

9.1 GENERAL

In circumstances where the 10m setback distance between the building and the edge of the classified vegetation cannot be achieved, those elements of the building that are less than 10m from the edge of the classified vegetation shall conform with AS1530.8.2.

*Therefore Section 9.4.1 (b) A System conforming with AS1530.8.2 when tested from outside. **MUST BE MET.**
 The concessions (a) and (c) and (d) cannot be used to meet compliance*

**TBA FIREFLY™ AS1530.8.2
 BAL-FZ WALL SYSTEM**

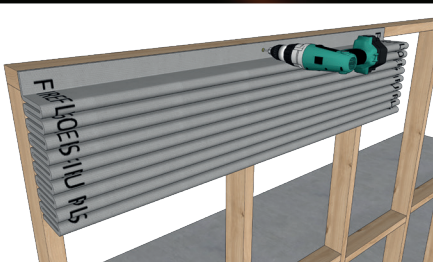

Installing the TBA Firefly™ Plus 60 RS to the timber frame



TBA Firefly™ Plus 60 RS & Steel Top Hats



TBA Firefly™ Non-Combustible Sarking & Steel Sheet Cladding