

TBA FIREFLY™

PASSIVE FIRE PROTECTION

TBA Textiles Pty Ltd

ABN: 30 161 422 359

Issue Date: 05/05/2022

17a

PHONE: (07) 5411 4209 (Option 2)
OR (02) 8004 3333 (Option 2)

WEBSITE: tbafirefly.com.au
EMAIL: sales@tbafirefly.com.au

In accordance with AS3959-2009 and AS3959-2018, homes that are to be built in areas designated as BAL-40 the Fascia element of construction needs to have passed AS1530.8.1 or alternatively a product that has passed the higher test standard AS 1530.8.2 may be used to satisfy all lower BAL's.

Noggin out between the rafters ensuring the noggins are flush to the top and bottom of the crown ends. (Noggins can be 3" X 2" timber or 70mm steel partition track)



Mechanically fix the TBA Firefly™ Plus 60 to the noggins using 25mm X 0.6mm steel hoop iron using 32mm drywall screws @ 100mm centres.

Overlay the top and front of the TBA Firefly™ Plus 60 with Intubatt® FZ. Adhere all joints with Intucoat Mastic and screw fix through the Intubatt® FZ and TBA Firefly™ Plus 60 into the timber noggins using 70mm drywall screws and penny washers @ 600mm centres.



TBA FIREFLY™
BAL-40 FASCIA SYSTEM

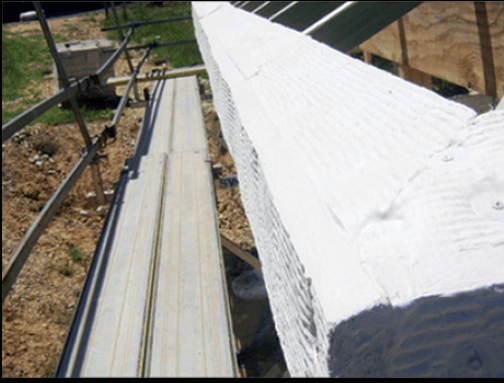

Overcoat all joints, edges and screw/washer heads with Intucoat mastic ensuring a sea of white and no gaps on completion.

Lay sarking over the top of the Intubatt® FZ ensuring ample overlap is left around the perimeter. Once the gutter is installed the sarking can be trimmed to length allowing the standard 50mm lap into the gutter. Overlay the top of the sarking, directly above the Intubatt® FZ with 160mm wide x 100 high TBA Firefly™ Party Wall Batt. When the steel roofing sheets are installed, the TBA Firefly™ Party Wall Batt will squash up into the profile of the steel sheeting, creating a secure seal against flame and ember attack.



Section Drawing

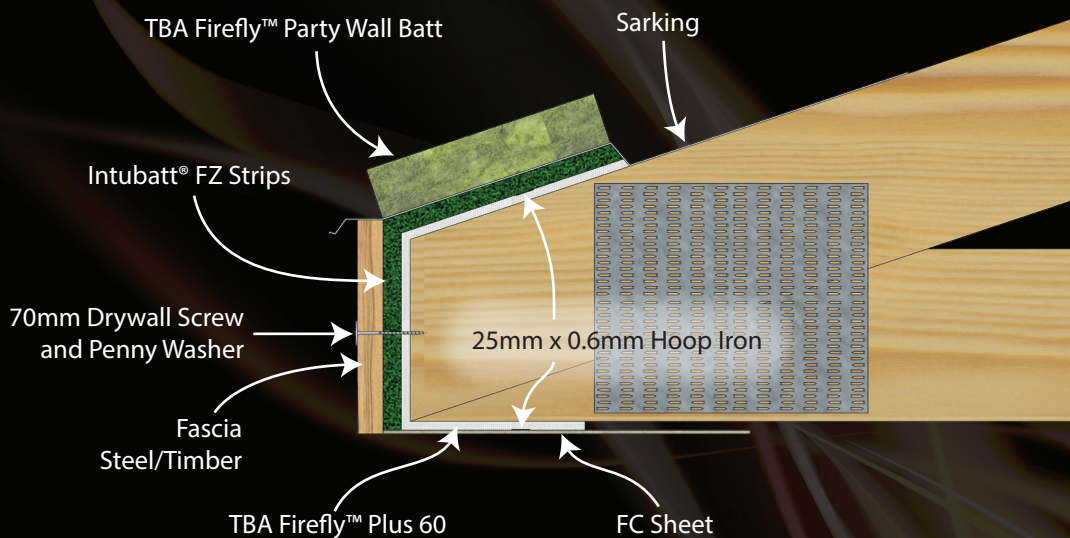

**TBA FIREFLY™
BAL-40 FASCIA SYSTEM**