

# Installation Manual

## TBA Firefly™ Vulcan R0.2 Non-Combustible Thermal Break

Pads

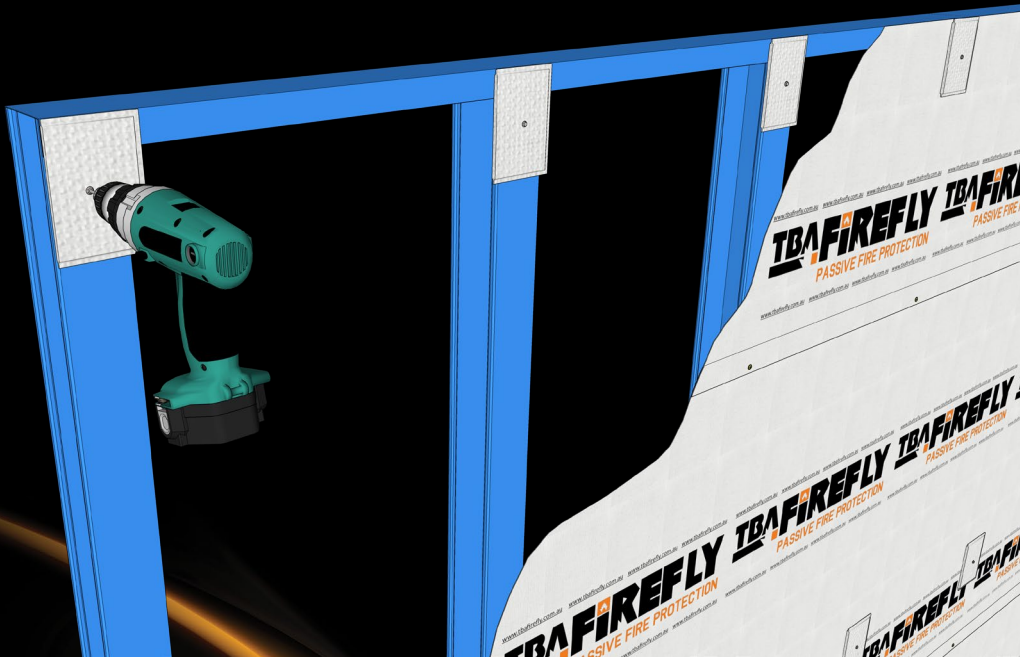

Strips

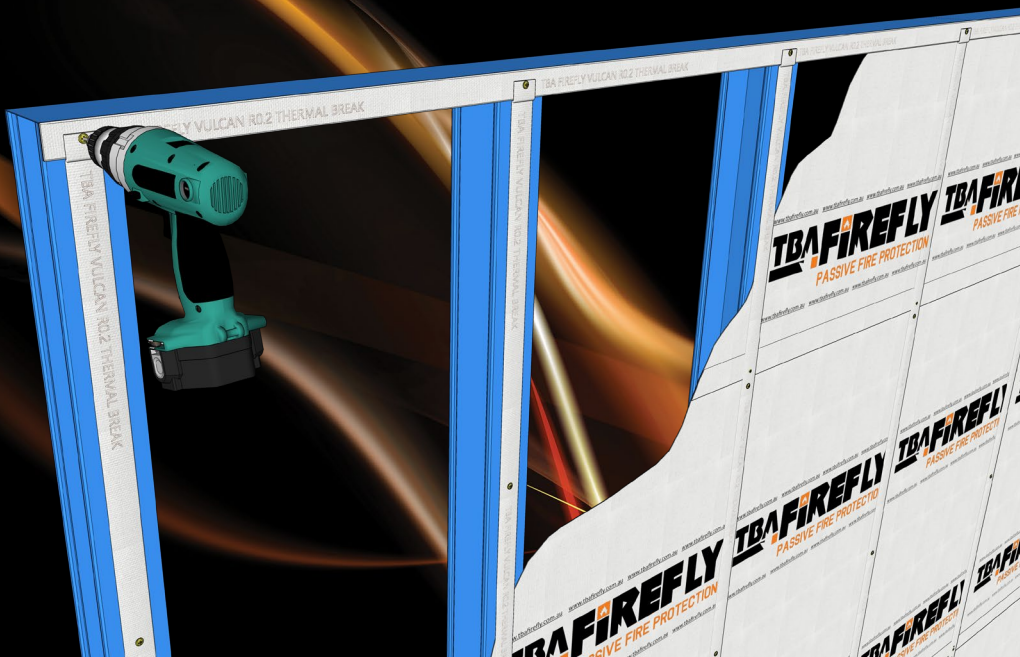

**TBA Firefly™ Thermal Break Pads are used to Create an R0.2 Thermal Break  
Between a Metal Framework and Metal Horizontal Top Hats  
at Their Point of Contact**

**TBA Firefly™  
Thermal Break Pads  
150mm x Long x 90mm Wide  
(100mm Including Stitch Line)  
x 6mm Thick**

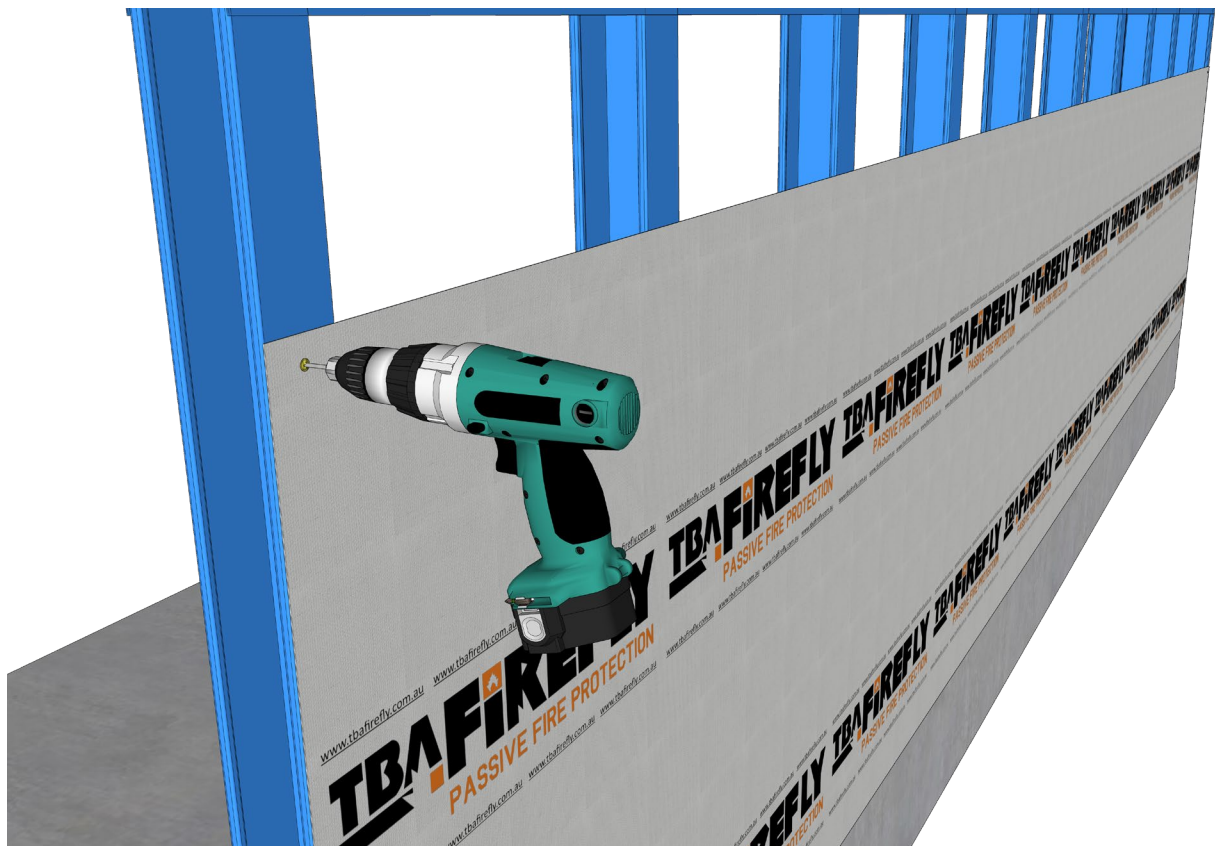

**Step 1.** Install a suitable Non-combustible Sarking to the metal framework.



**Step 2.** Start to Install the TBA Firefly™ Pads, ensure they sit centrally in front of each stud on the proposed horizontal line of where the Top Hats are to be Installed then secure them with a single Min' 15mm long Button (Pan) Head self-drilling screw positioned centrally in the TBA Firefly™ Pad.

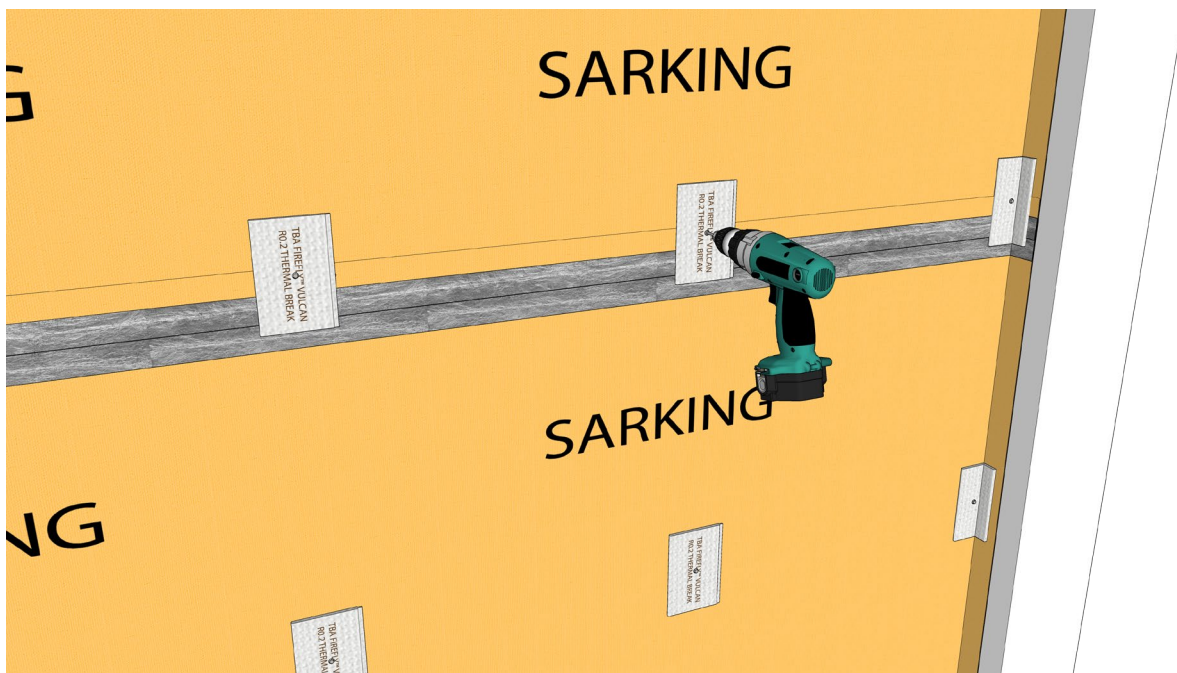

**Step 3.** Continue to Install the TBA Firefly™ Pads to ensure that every point of contact is Isolated using the Thermal Break. For corners and abutments, simply fold the pad in half at the junctions so that when the Top Hats are Installed, they are also Isolated at their edges too.

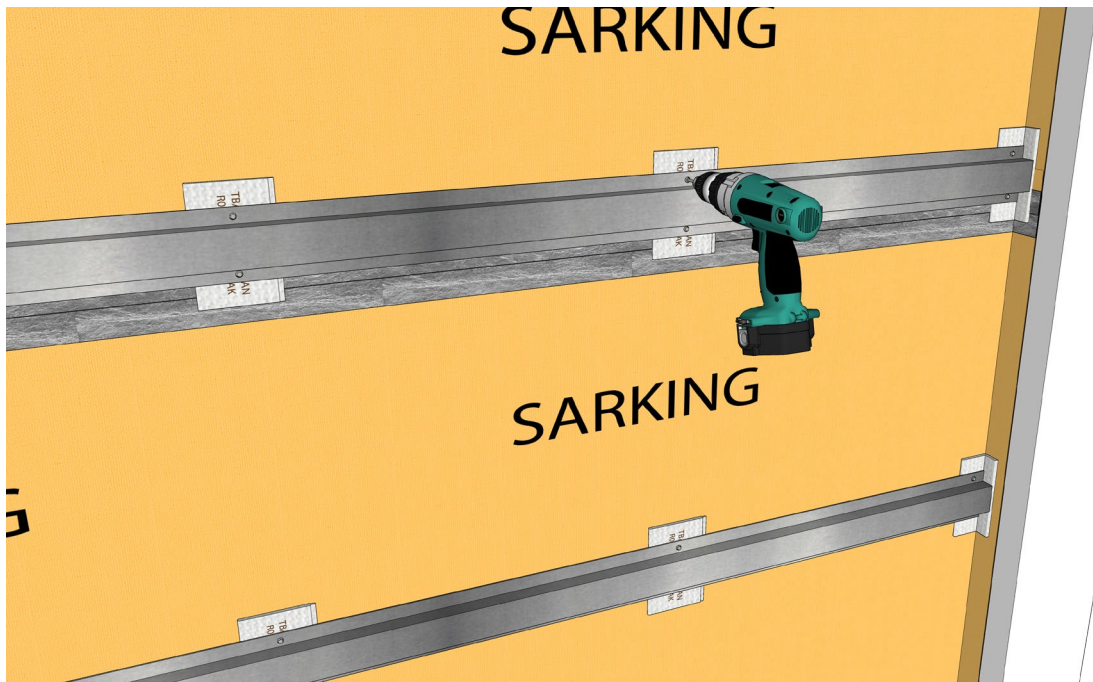

**Step 4.** Then Install the horizontal Top Hats over the TBA Firefly™ Pads and secure them to the frame. Top Hats should be Installed at the relevant spacing and secured using the relevant fixings specified by the Cladding Manufacturer.



**Step 5.** The Top Hats are now ready to receive the cladding.

**TBA Firefly™ Thermal Break Strips are used to Create an R0.2 Thermal Break Between a Metal Framework and Metal Vertical Top Hats or Directly Fixed Cladding at Their Point of Contact**

**TBA Firefly™  
Thermal Break Strips  
10m x Long x 90mm Wide  
(100mm Including Stitch Line)  
x 6mm Thick**



**TBA Firefly™  
AFRT  
Non-combustible  
Aluminium Foil  
Reinforced Tape**



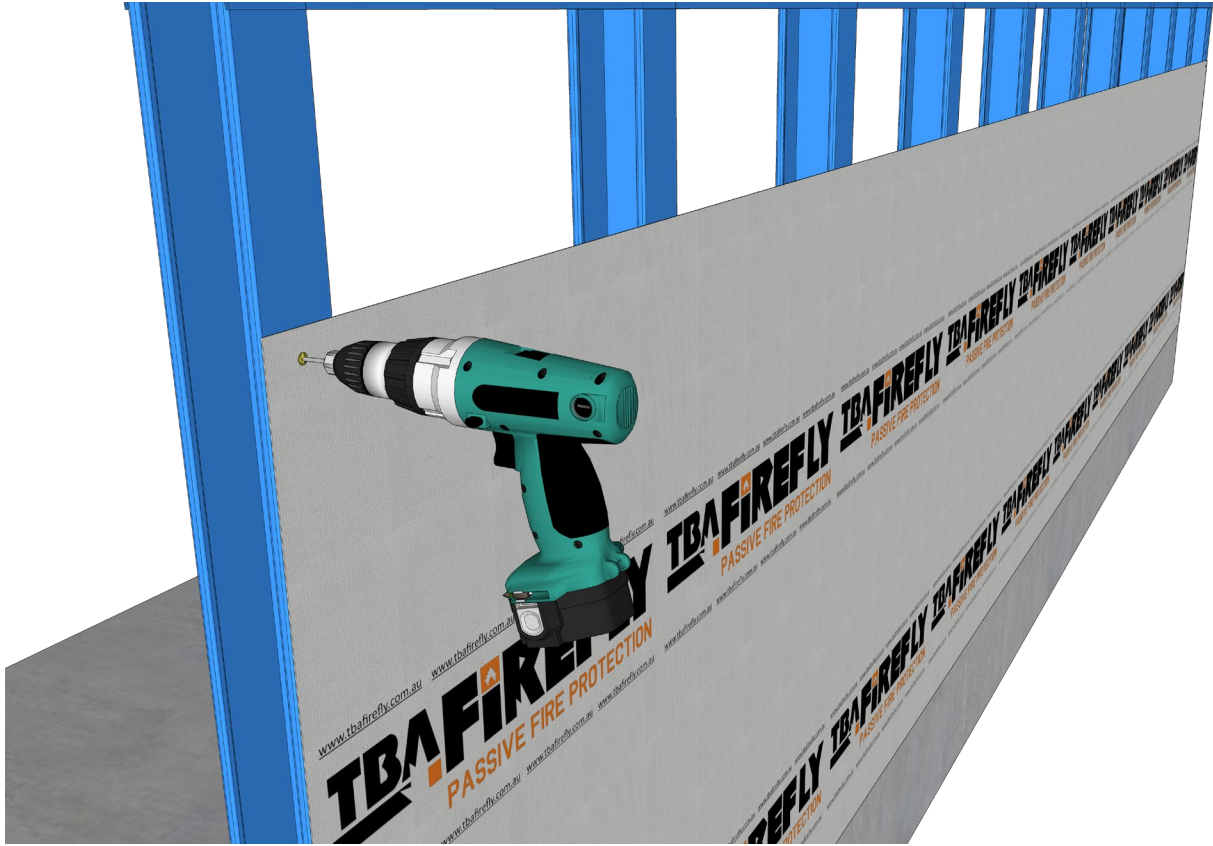

**Step 1.** Install a suitable Non-combustible Sarking to the metal framework.

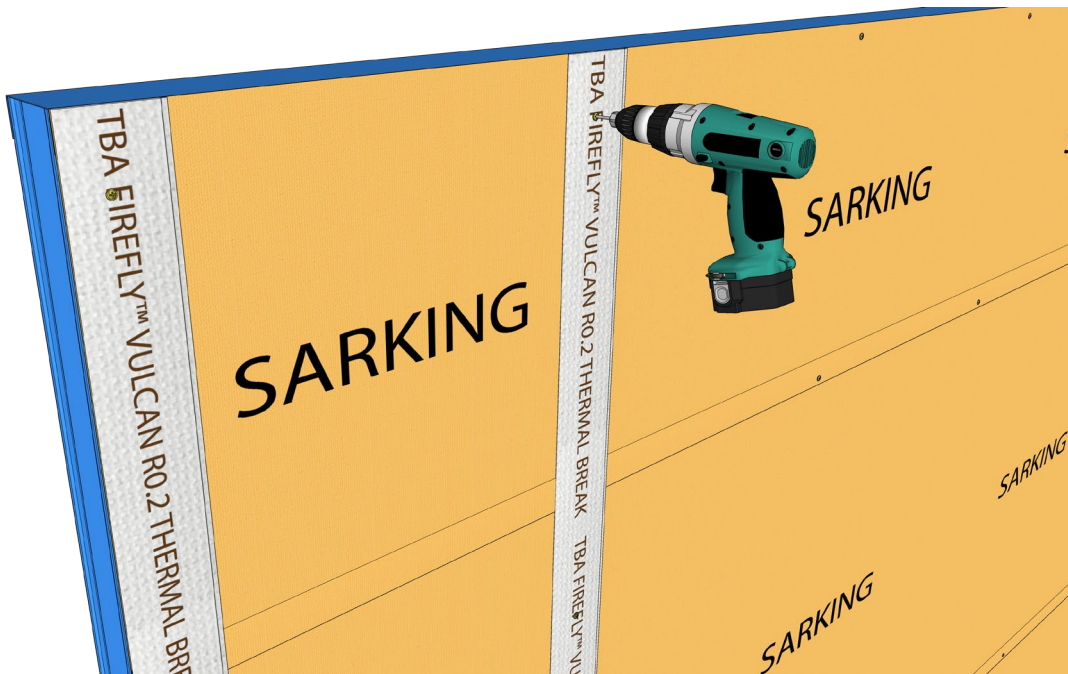

**Step 2.** For Directly Fixed Cladding the TBA Firefly™ Strips need to be Installed over the face of the top/bottom track and the studs. For Vertical Top Hat Installations, the TBA Firefly™ Strips only need to be Installed over the face of the Studs. Ensure they sit squarely in front of the top/bottom tracks & centrally over the studs and secure them with Min' 15mm long Button (Pan) Head self-drilling screws @ Maximum 50mm from each end, then @ Nominal 600mm centres.

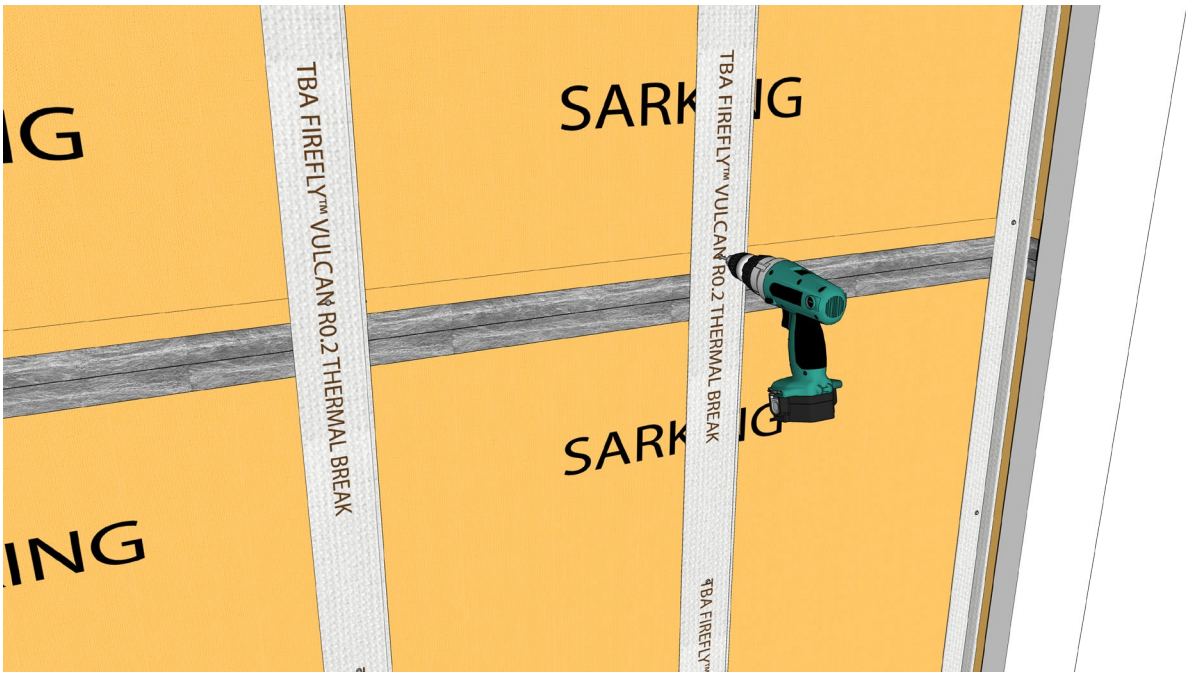

**Step 3.** Continue to Install the TBA Firefly™ Strips to ensure that every point of contact is isolated using the Thermal Break. For corners and abutments, simply fold the TBA Firefly™ Strip in half at the junctions so that when the Top Hats are Installed, they are also isolated at their edges too. For Directly Fixed Cladding a Horizontal TBA Firefly™ Strip must be Installed over the top/bottom track too.



**Step 4.** Then Install the Vertical Top Hats or Directly Fixed Cladding over the TBA Firefly™ Strips and secure them to the frame. Top Hats and/or Cladding should be Installed at the relevant spacing/fixing centres and secured using the relevant fixings specified by the Cladding Manufacturer.

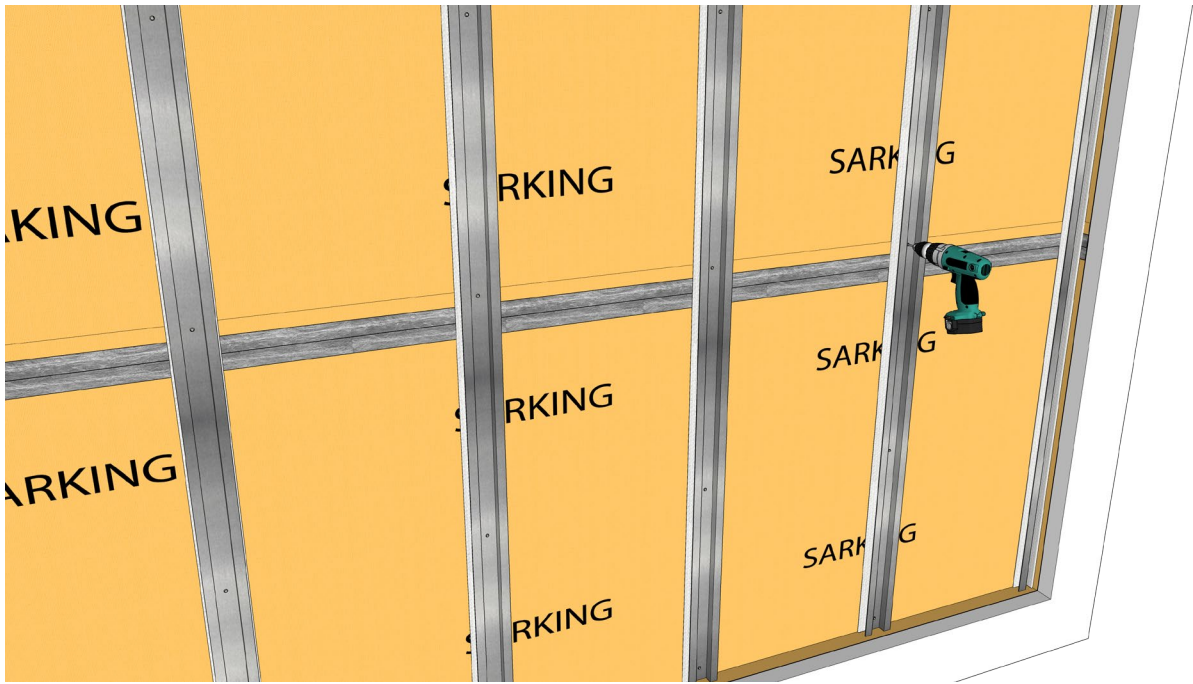

**Step 5.** The Top Hats are now ready to apply the cladding.

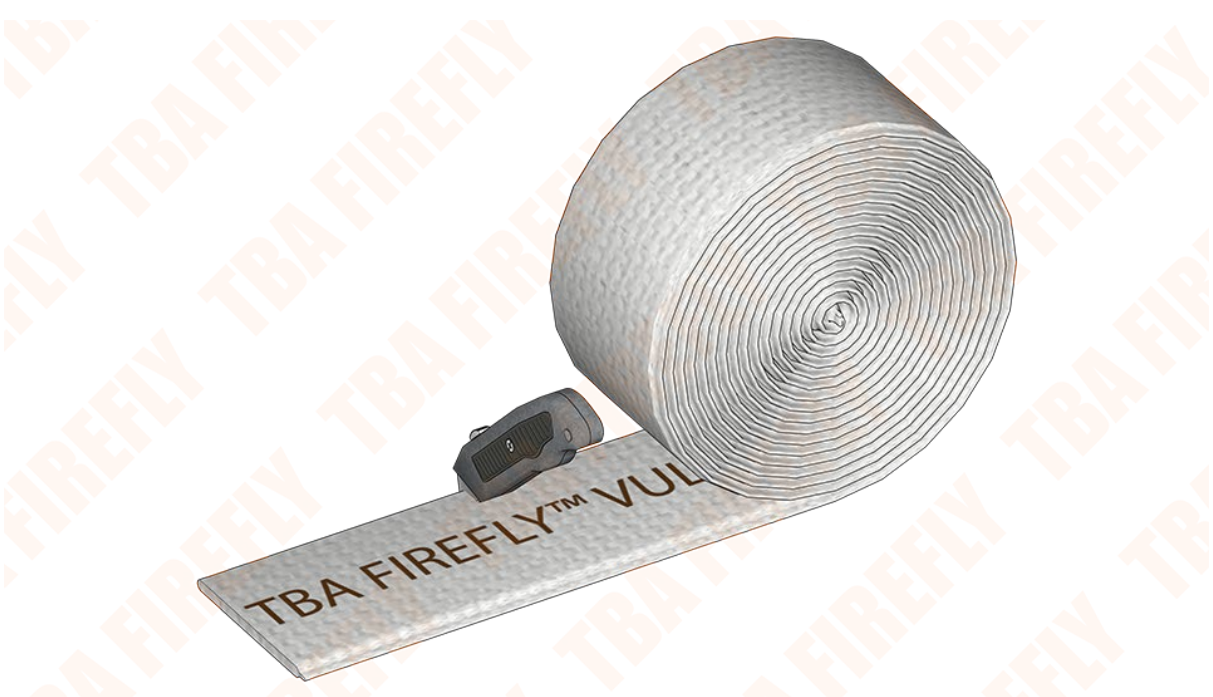

**Note:** The TBA Firefly™ Thermal Break Strips may be cut into Pads (Minimum 150mm Long) using a long-bladed Stanley Knife & sealed at the cut edges with TBA Firefly™ (AFRT) in lieu of purchasing the Ready Made TBA Firefly™ Thermal Break Pads.



**SALES ENQUIRIES**

T: 07 5411 4209 (Option 2) E: [Sales@tbafirefly.com.au](mailto:Sales@tbafirefly.com.au)  
T: 02 8004 3333 (Option 2) W: [www.tbafirefly.com.au](http://www.tbafirefly.com.au)